

	Imperial	Metric
Milling-Style Nose / Wash Head / Adaptor Material	P 110	
Chisel-Tip Cutters / Gauge Protection Dome Buttons	Tungsten Carbide	
Milling Style Head Blade / Nominal Diameter	2.880 in 3.500 in 3.560 in 3.625 in 3.730 in	73 mm 89 mm 91 mm 92 mm 95 mm
Milling-Style Head Total Flow Area	6 x Ø0.44 in (0.90 in <sup>2</sup> )	6 x Ø11.1 mm (582 mm <sup>2</sup> )
Wash Head Nominal Diameter	2.875 in 3.250 in	73 mm 83 mm
Maximum Wash Head Port Config & TFA	1 x Ø0.44 in, 12 x Ø0.31 in 1.07 in <sup>2</sup>	1 x Ø11.1 mm, 12 x Ø7.9 mm 690 mm <sup>2</sup>
Minimum Wash Head Port Config & TFA	6 x Ø0.31 in 0.46 in <sup>2</sup>	6 x Ø7.9 mm 297 mm <sup>2</sup>
Optional Bottom Adaptor Connection	2.375 PAC pin or box	
Maximum Temperature <sup>1</sup>	482°F	250°C

<sup>1</sup> - Specified ratings are not applicable at temperatures exceeding this value. Contact InFocus for ratings at elevated temperatures.

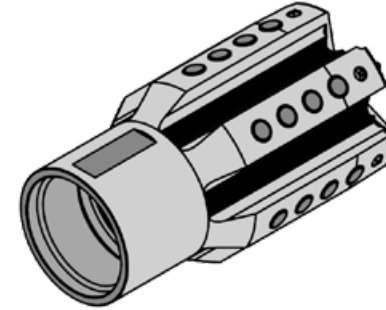

Convex Milling Style Nose  
Available sizes:  
3.500 in (89 mm), 3.560 in (91 mm), 3.625 in (92 mm), 3.730 in (95 mm)

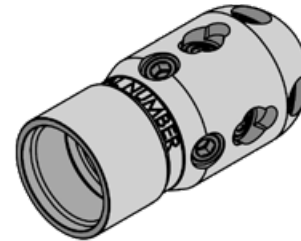

Wash Nose Assembly  
Available sizes:  
Ø2.875

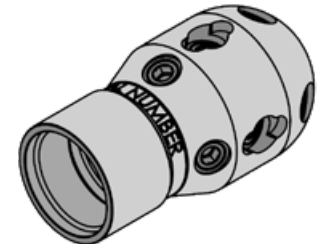

Wash Nose Assembly  
Available sizes:  
Ø3.250

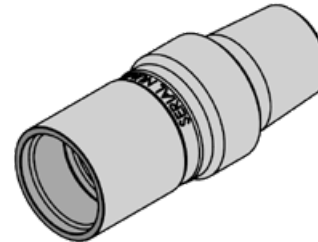

Milling Nose Adaptor  
2-3/8" PAC Pin

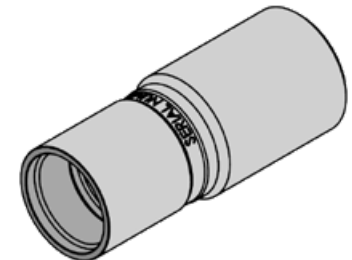

Milling Nose Adaptor  
2-3/8" PAC Box

Follow us!

