

	Imperial	Metric
Milling-Style Nose / Wash Head / Adaptor Material	P 110	
Chisel-Tip Cutters / Gauge Protection Dome Buttons	Tungsten Carbide	
Milling Style Wash Head	2.060 in	52.3 mm
Milling-Style Wash Nose Total Flow Area	6 x Ø0.44 in (0.90 in ²)	6 x Ø11.1 mm (582 mm ²)
Recommended Total Flow Area	0.45 in ²	293 mm ²
Wash Head Nominal Diameter	2.600 in 2.500 in	66 mm 63.5 mm
Maximum Wash Head Port Config & TFA	1 x Ø0.44 in, 12 x Ø0.19 in 0.48 in ²	1 x Ø11.1 mm, 12 x Ø4.8 mm 310 mm ²
Minimum Wash Head Port Config & TFA	6 x Ø0.19 in 0.17 in ²	6 x Ø4.8 mm 110 mm ²
Optional Bottom Adaptor Connection ¹	1.500 API REG Pin / Box	
Maximum Temperature ²	482°F	250°C

¹ - 1.500 API REG Connection is interchangeable with most 1.500 MT, 1.500 AMT and 1.500 AMMT connections.

² - Specified ratings are not applicable at temperatures exceeding this value. Contact InFocus for ratings at elevated temperatures.



Milling Style Wash Nose Assembly
Size:
Ø2.060

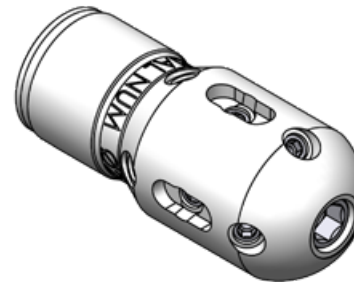

Wash Nose Assembly
Size:
Ø2.500

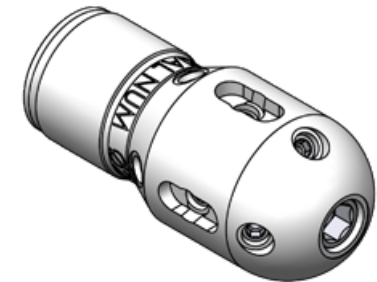

Wash Nose Assembly
Size:
Ø2.600



Box Down Crossover Sleeve
1.500 API REG



Pin Down Crossover Sleeve
1.500 API REG

Follow us!

